

## SN57LS-1 Back

Insert Included O-ring in groove  
on back of adapter. Lubricate  
O-ring with engine oil.

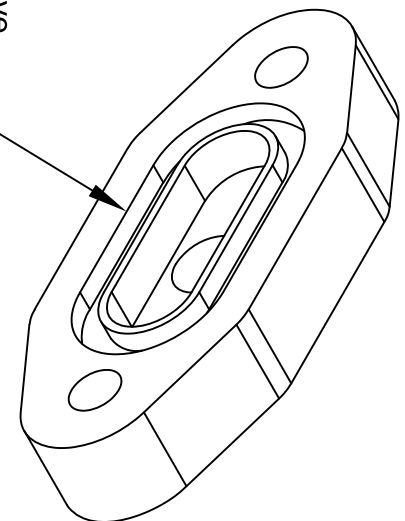

## SN57LS-1 Front

Attach oil pressure sender  
in  $\frac{1}{8}$ " NPT hole. DO NOT  
use teflon tape on threads.

Use 2x included M6 x 1mm  
screws to attach to engine.  
Torque screws to 9-10 ft. pounds.  
Blue Loc-tite is recommended to  
be used on screw threads.

